

CLEANING

Introduction

The perfect coffee experience depends on a perfectly cleaned coffee machine, cooling unit and Flavor Station (option). Increase your product quality! Clean your coffee machine and add-on units at least once a day and more frequently if necessary.

The automatic cleaning process includes the cleaning of the coffee machine and the cooling unit (if present).



NOTICE

Dirty components

Dirty components can have a negative effect on the function of the machine and the quality of beverages.

a) Clean the removable components using the 5-step method.



The removable components of the coffee machine are not dishwasher-safe.



Rinsing is not a substitute for daily cleaning! Rinsing is necessary to remove residue build-up in the coffee and milk systems.

The machine automatically rinses after certain time intervals as well as when it is switched on or off.

Required cleaning accessories

- Cleaning tablets
- Microfiber cloth
- Paint brush
- Brush set
- Cleaning agent cartridge (for cooling unit/Flavor Station with EC)
- Collecting container (only on machines with no wastewater connection)
- Cleaning container (SU05)

5-step method



Clean the removable components of your coffee machine using the 5-step method. The display shows you the components that can be removed during cleaning.

Clean the container and accessories of the cooling unit

Clean the containers and accessories, such as the lid, suction hose, suction nozzle, etc. using the 5-step method.

1. Remove coarse dirt with a cleaning brush or paint brush.
2. Soak the components in hot water with a mild cleaner.
3. Wash the components.
4. Rinse the components thoroughly.
5. Dry the components.

Additional areas to be cleaned by hand

- Inner side of the door and door gasket on cooling unit

Cleaning instructions A300

- Inner surfaces and shelf (if applicable) in the cooling chamber

Starting the cleaning process



When the cleaning cycle is complete, the machine either switches back to the maintenance level or the energy saving mode. Your service technician can set the desired option for you.

Starting cleaning via the Cleaning and Maintenance menu



1. Tap the Franke logo.



2. Enter the PIN (1111).

3. Press Ok.
4. Select Cleaning and maintenance.

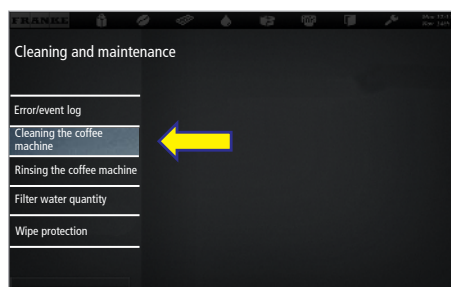

5. Select Clean coffee machine.
6. Confirm message with Yes to begin the cleaning process.
7. Follow the instructions on the user interface and confirm the completed steps by selecting Next.

⇒ The machine shows the next step.

Loosen bean hopper finger guard for cleaning



The bean hopper finger guard prevents injuries caused by the grinder. The finger guard may only be removed for cleaning.

- ✓ The coffee machine is switched off and disconnected from the power supply.
- ✓ A hexalobular 10 screwdriver is provided.

1. Remove the container lid.

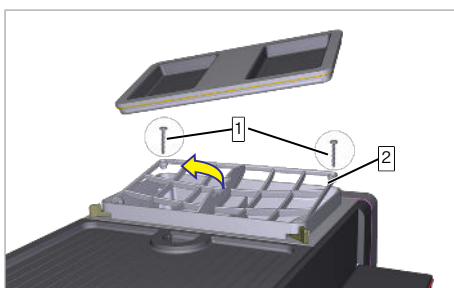

2. Loosen both screws [1] and remove the finger guard [2].

3. Clean the bean hopper and the protective grid.
4. Attach the dried finger guard with both screws.
5. Connect the coffee machine to the power supply.

Weekly cleaning



Clean the machine components listed in this chapter at least once a week, in addition to the daily cleaning process. Clean the machine immediately if you notice any soiling.

Cleaning the machine surface

1. Clean the surface of the machine with a damp cloth.
2. If necessary, use a mild cleaner. **NOTICE! Do not use abrasive cleaners.**

Cleaning the water tank (if present)



Check the water tank daily for dirt or limescale. Clean the appliance immediately if it is dirty or has lime scale.



1. Remove and empty the water tank [1].

2. Clean the water tank using the 5-step method.

Cleaning the powder hopper

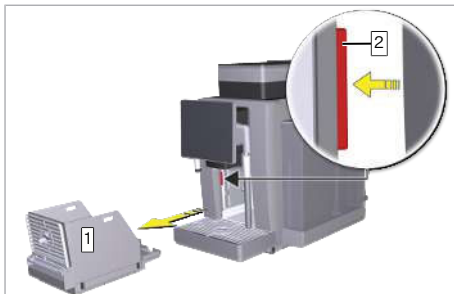

1. Remove the grounds container [1].
2. Open the door lock (option) with the key.
3. Press the latch [2] on the inside and open the door.

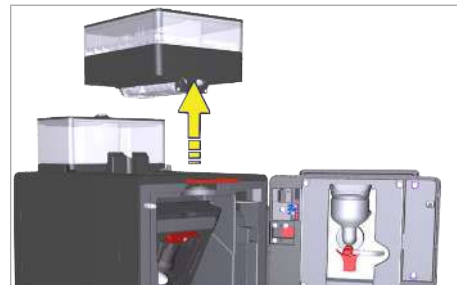

5. Raise and remove the powder hopper.
6. Empty the powder hopper.
7. Clean the powder hopper with a cloth. Use detergent if necessary. Wipe the inside of the hopper with a dry cloth.
8. Attach the powder hopper.
9. Push in the locking slide.
10. Close the door and insert the powder hopper.

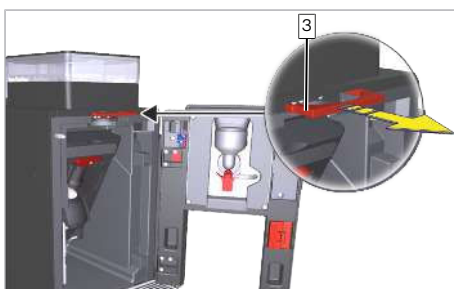

4. Pull the locking slide [3].

Clean the drip tray and drip grid.



NOTICE

Escaping liquid

Applies to machines with a wastewater connection! On machines with a wastewater connection, if water remains in the drip tray, this can escape when the drip tray is removed.

- a) Before removing the drip tray, ensure that the remaining water has drained.

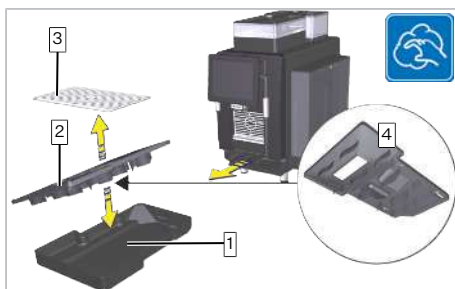

1. Clean the drip tray [1], the drip tray lid [2] and the drip grid [3] using the 5-step method.

2. Thoroughly clean the projecting features on the underside [4] of the drip tray lid [2].



The rear of the drip tray [1] must be clean and dry, both inside and out. If it is not, this may cause the drip tray's continuous level sensor to issue an alert in error.

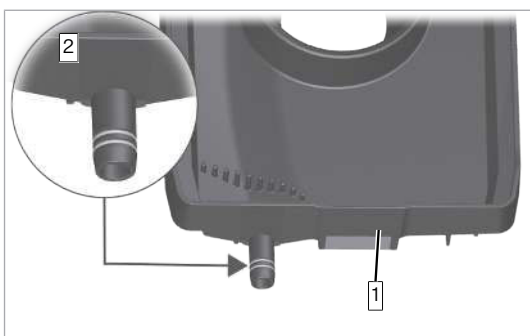

If the coffee machine is connected to the wastewater system, there are two O-rings on the back of the drip tray [2]. These must be moistened with water so that the drip tray can fully engage. Otherwise, the capacitive sensor cannot detect the drip tray.

Cleaning the screen

1. Tap the Settings symbol at the top left.
 2. Select Cleaning and Maintenance.
 3. Select Wipe protection.
 4. Clean the surface with a damp cloth.
- ⇒ The user interface is locked for 20 seconds.